

EUROPEAN & DOMESTIC STYLE

TOWER PARTS

PART	DESCRIPTION
01038	Medallion Holder - Shank Style Round-Angled - Chrome
01039	Medallion Holder - Shank Style Round-Straight-Short - Chrome
01040	Medallion Holder - Shank Style Round-Straight-Tall - Chrome
01041	Medallion Holder - Front Round Chrome
01042	Medallion Round - Blank White - Ceramic
*01452	Ceramic Acorn Nut - Specify Tower & Colour
*01453	Ceramic Collar or Base - Specify Tower & Colour
*01454	Ceramic Lid - Specify Tower & Colour
*01083	Medallion Holder - Shank Style Round-Angled - Gold
*01084	Medallion Holder - Shank Style Round-Straight-Short - Gold
*01085	Medallion Holder - Shank Style Round-Straight-Tall - Gold
*01086	Medallion Holder - Front Round - Gold



TOWER SHANKS

PART	DESCRIPTION
*01014	1 3/4" Threaded for Nut Gland/Elbow-No Parts
01025	1 3/4"- 3/16" Elbow Excludes Collar, Snap Ring etc.
01027	Adapter for Chrome Stout Faucet on Cobra Tower
01057	Adapter for Brass Stout Faucet on Cobra Tower
01060	Complete Assembly 5/8" w/Nut Gland & Elbow Short-Chrome
01061	Complete Assembly 5/8" w/Nut Gland & Elbow Long-Chrome
01062	Complete Assembly 5/8" w/Nut Gland & Elbow Short-Brass
01063	Complete Assembly 5/8" w/Nut Gland & Elbow Long-Brass
01067	1 5/8" with Down Tube excludes Collar, Snap Ring etc.
01080	1 1/2" Wine with 3/16" Elbow
02335	Celli Flow Control-Chrome
02336	Celli Flow Control-Brass
02337	Celli N.A. Style-Chrome
02338	Celli N.A. Style-Brass

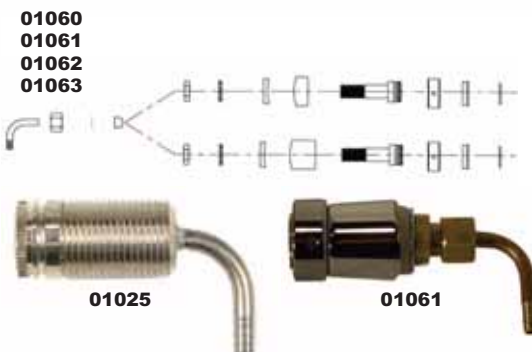

TOWER FITTINGS

PART	DESCRIPTION
01448	Mounting Bolts
01449	Mounting Nuts
01450	Mounting Washers
01451	Mounting Lock Washers
01480	Gasket for Cobra Base



TOWER PARTS

*Special order items.

STANDARD SHANKS & PARTS

STANDARD SHANKS

PART	DESCRIPTION
01015	3" Chrome Parts Kit - Black Plastic Flange
01016	4 1/8" Chrome Parts Kit - Black Plastic Flange
01017	5 1/8" Chrome Parts Kit - Black Plastic Flange
*01018	6" Two Product - Chrome no parts
01019	8" Chrome Parts Kit - Black Plastic Flange
01020	10" Chrome Parts Kit - Black Plastic Flange
*01021	12" Two Product - Chrome no parts
01022	14" Chrome Parts Kit - Black Plastic Flange
01023	3 1/2" - 3/16" Barb - Chrome Parts Kit - Black Plastic Flange
01026	3" Chrome Ice Box Style - Excludes Collar, Snap Ring, etc.
01081	3" Wine - Plastic
01082	8" Wine - Plastic
01356	4" Chrome Ice Box



01015
01016
01017
01019
01020
01022



01018
01021



01026

SHANK PARTS

PART	DESCRIPTION
01024	Flange Locking for 01023
01028	Snap Ring for N.A.
01029	Shank Sleeve - Chrome
01030	Coupling Nut Gripped - Chrome
01031	Flange Black Wall - Plastic
01032	Flange Flat Wall - Chrome
01033	Nut N.A. 7/8"
01034	Coupling Nut Smooth - Chrome
01051	Flange 7/8" Flared Chrome for Tower Shank outside
01052	Flange 1" Straight Chrome for Shank
01053	Flange 3/4" Straight Chrome Hex Key for Cobra
01054	Flange 7/8" Flared Brass for Tower Shank outside
01055	Flange 1" Straight Brass for Shank
01056	Flange 3/4" Straight Gold Hex Key for Cobra
01058	Flange 7/8" Flared Plastic for Tower Shank inside
01059	Rubber 3/16" Gland
01064	Washer - 7/8" Flat - Aluminum
01065	Washer - 7/8" Locking - Aluminum
01075	Shank Sleeve - Brass
01076	Coupling Nut Gripped - Brass
01077	Flange Flat Wall - Brass
01078	Coupling Nut Smooth - Brass
01100	Cold Block U/C 1 Tap - Aluminum
01101	Cold Block U/C 2 Tap - Aluminum
01493	Plug (Replaces Faucet)



01081
01082



01356



01028 01029 01030 01031 01033



01032



01052



01024



01493



01064

*Special order items.

SHANKS